

Parcel: 43-00524-000

Year: 2023

LARRY LINDBERG

Tuscarawas County Auditor | Tuscarawas County, Ohio



SUMMARY

Table with property details: Deeded Name, Owner, Tax District, School District, Neighborhood, Location, CD Year, Acres, Taxpayer, Land Use, Class, Subdivision, Legal, Routing Number, Sales Amount.

VALUE

Table with value breakdown: District, Land Use, Appraised, Assessed, Land, Improvement, Total, CAUV, Homestead, OOC, Taxable.

CURRENT CHARGES

Table with current charges: Full Rate, Effective Rate, Qualifying Rate, and a detailed breakdown by period (Prior, First, Second, Total).

FUTURE CHARGES

Table with future charges: Type, Description, Amount.

TRANSFER HISTORY

Table with transfer history: Date, Buyer, Conveyance, Deed Type, Sales Amount, Valid, # of Properties.

LAND

Table with land details: Type, Dimensions, Description, Value.

DWELLING

Table with dwelling details: Card 1, Style, Stories, Rec Room Area, Finished Basement, Rooms, Bed Rooms, Dining Rooms, Heating, Cooling, Grade, Fireplace Openings, Fireplace Stacks, Living Area, Total Area, Value.

OTHER IMPROVEMENT

Table with other improvements: Card Type, Year Built, Year Remodeled, Condition, Dimensions, Description, Size, Value.

SKETCH

Card 1

ID	Description	Size	Floor	Floor Area (ft ²)	Living Area (ft ²)
A	1.5SFR/B (1.5 STORY FRAME / BASEMENT)	768	First Floor	1,165	1,165
B	OFF (OPEN FRAME PORCH)	48	1/2 Upper Floor	768	384
C	OFF (OPEN FRAME PORCH)	56	Basement	768	0
D	1SFR/C (1 STORY FRAME / CRAWL)	397	Total	2,701	1,549
E	OFF (OPEN FRAME PORCH)	35			
1	DFG-DETACHED FRAME GARAGE	308			

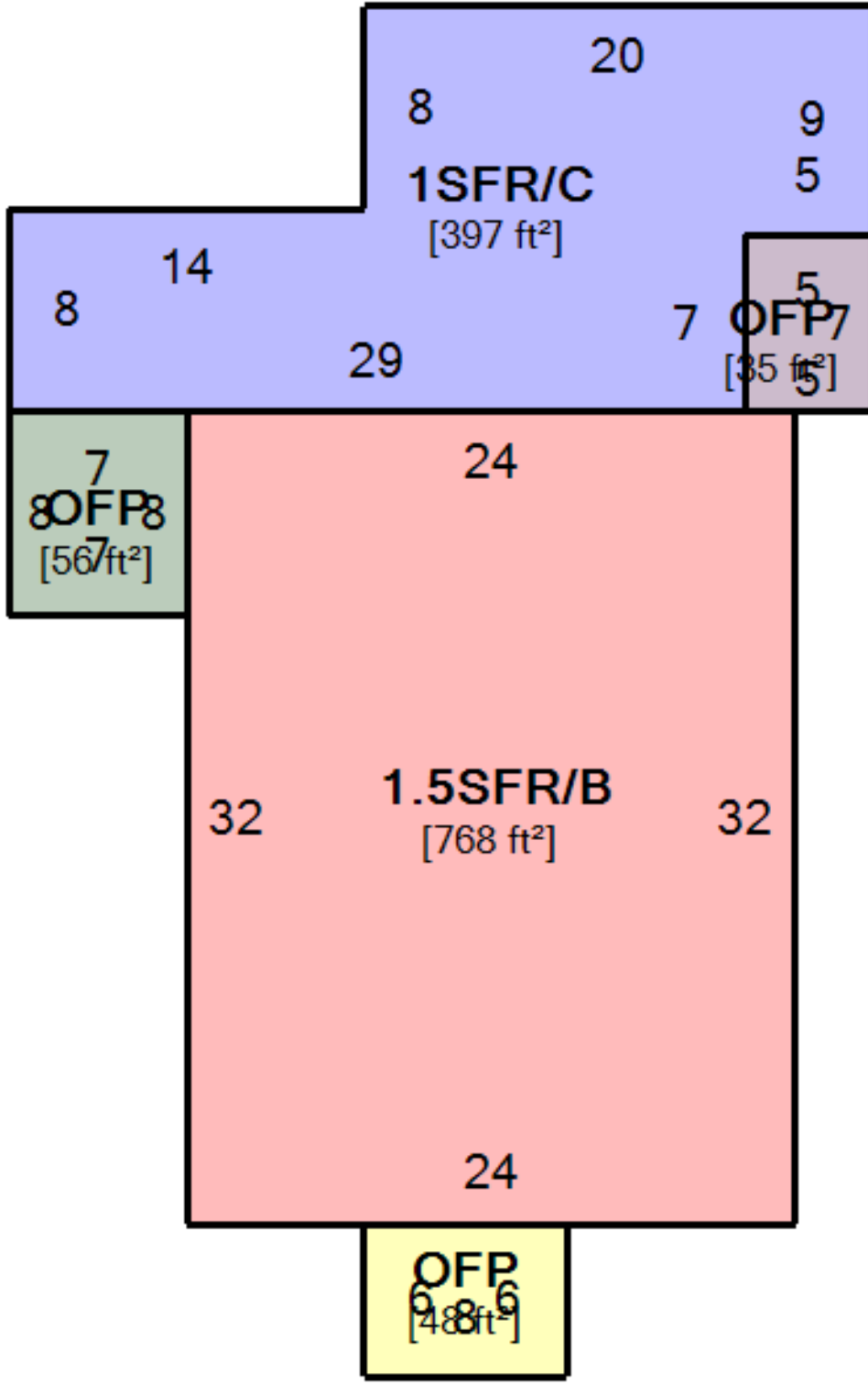

1