

Parcel: 43-00524-000

Year: 2024

LARRY LINDBERG

Tuscarawas County Auditor | Tuscarawas County, Ohio



SUMMARY

Table with property details: Deeded Name, Owner, Tax District, School District, Neighborhood, Location, CD Year, Acres, Taxpayer, Land Use, Class, Subdivision, Legal, Routing Number, Sales Amount.

VALUE

Table with value breakdown: District, Land Use, Appraised, Assessed, Land, Improvement, Total, CAUV, Homestead, OOC, Taxable.

CURRENT CHARGES

Table with current charges: Full Rate, Effective Rate, Qualifying Rate, and a detailed table with Prior, First, Second, Total columns.

TRANSFER HISTORY

Table with transfer history: Date, Deed Type, Volume / Page, Sales Amount, Valid Conveyance #, Exempt, # of Properties.

LAND

Table with land details: Type, Dimensions, Description, Value.

DWELLING

Table with dwelling details: Card 1, Style, Stories, Rec Room Area, Finished Basement, Rooms, Bed Rooms, Dining Rooms, Heating, Cooling, Grade, Fireplace Openings, Fireplace Stacks, Living Area, Total Area, Value.

SKETCH

Card 1

ID	Description	Size	Floor	Floor Area (ft <sup>2</sup> )	Living Area (ft <sup>2</sup> )
A	1.5SFR/B (1.5 STORY FRAME / BASEMENT)	768	First Floor	1,165	1,165
B	OFF (OPEN FRAME PORCH)	48	1/2 Upper Floor	768	384
C	OFF (OPEN FRAME PORCH)	56	Basement	768	0
D	1SFR/C (1 STORY FRAME / CRAWL)	397	Total	2,701	1,549
E	OFF (OPEN FRAME PORCH)	35			
1	DFG-DETACHED FRAME GARAGE	308			

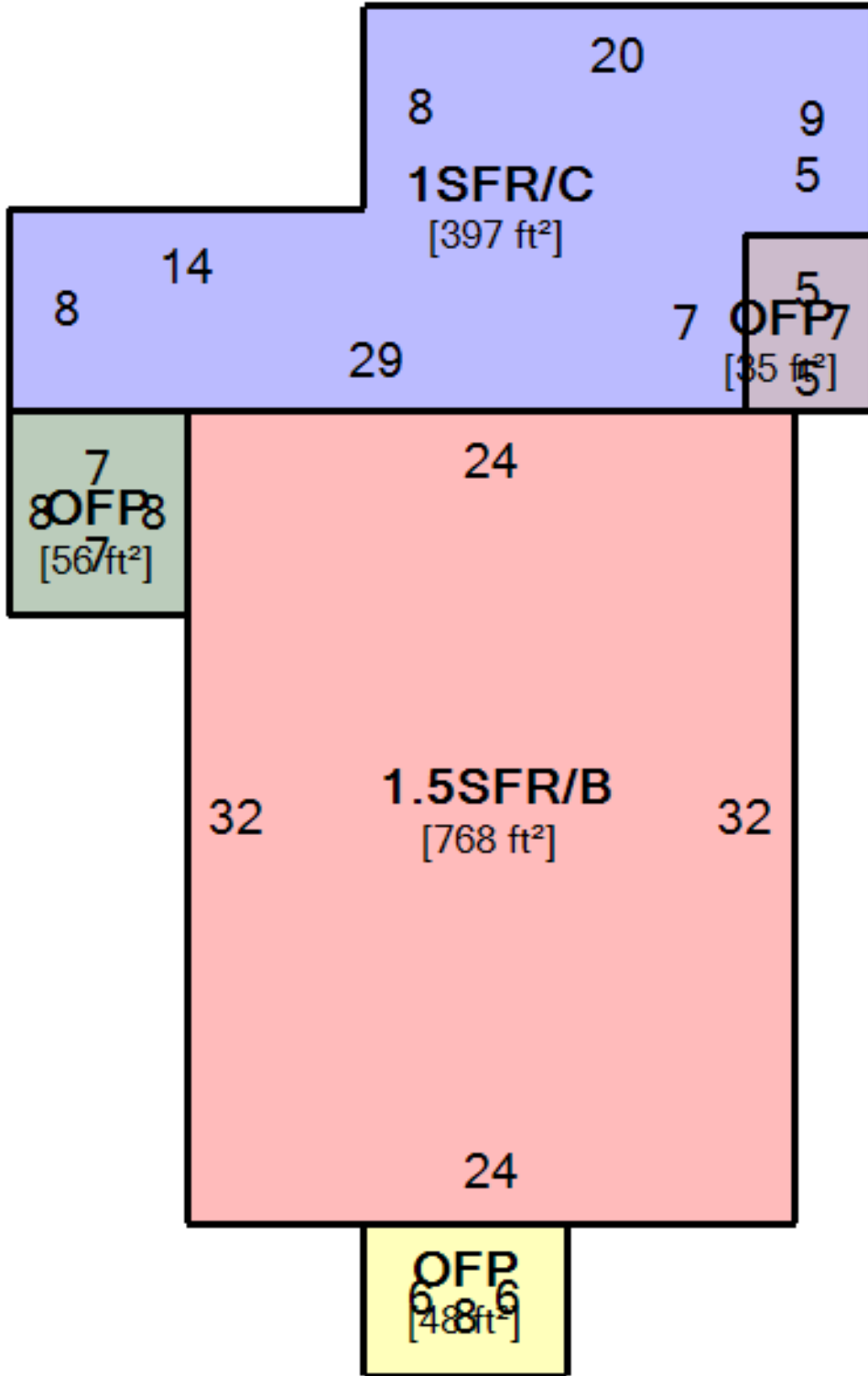

**1**